

MATING HEIGHT

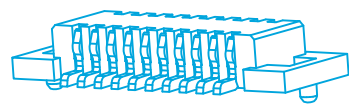

3D VIEW

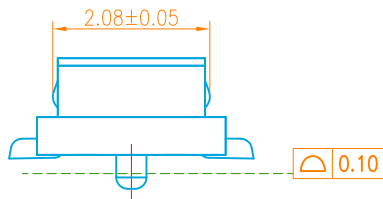
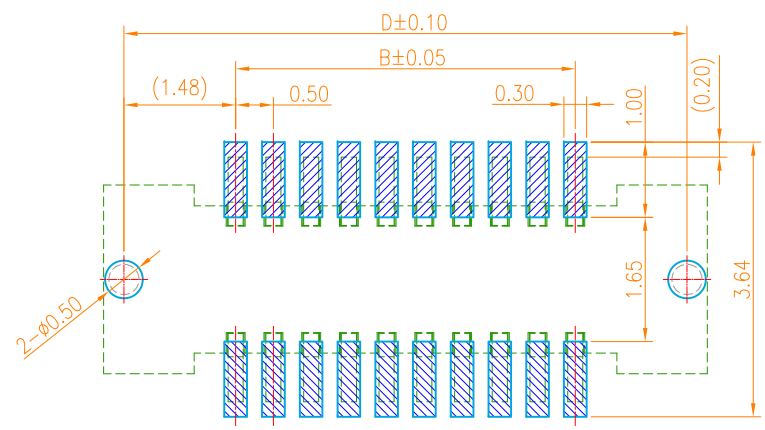

NOTES:

- 1.HUOSING: LCP HIGH-TEMP THERMOPLASTIC UL94V-0 COLOR:BEIGE
- 2.TERMINAL:PHOSPHOR BRONZE  
PLATING:1\*''GOLD FLASH OVERALL 50~100\*''NICKEL UNDER PLATED.
- 3.CODING INFORMATION: LB615-GxxP-C1R

- PACKING: R: CARRIER REEL WITH POST TYPE
- COLOR:BEIGE
- PLUG
- PIN
- PLATING: G:GOLD FLASH
- 0.5 BTB HEIGHT: 15--1.5H
- LXWCONN BTB CONNECTOR SERIES

NO.of contacts	Dimensions			
	A.	B.	C.	D.
10	5.50	2.00	3.45	4.96
12	6.00	2.50	3.95	5.46
16	7.00	3.50	4.95	6.46
18	7.50	4.00	5.45	6.96
20	8.00	4.50	5.95	7.46
14	6.50	3.00	4.45	5.96
16	7.00	3.50	4.95	6.46
18	7.50	4.00	5.45	6.96
20	8.00	4.50	5.95	7.46
22	8.50	5.00	6.45	7.96
24	9.00	5.50	6.95	8.46
26	9.50	6.00	7.45	8.96
28	10.00	6.50	7.95	9.46
30	10.50	7.00	8.45	9.96
32	11.00	7.50	8.95	10.46
36	12.00	8.50	9.95	11.46
40	13.00	9.50	10.95	12.46
50	15.50	12.00	13.45	14.96
100	28.00	24.50	25.95	27.46

RECOMMENDED PCB PATTERN DIM.  
TOLERANCE : ±0.05

**CUSTOMER**  **连兴旺电子(深圳)有限公司**  
LXWCONN ELECTRONICS (SHENZHEN) CO., LTD

一般公差 GENERAL TOLERANCE	制图 (DR): Kavin 2017.10.23	品名(TITLE): 0.5mm 单槽BTB PLUG (定位柱)
.X ±0.25 .XX ±0.15 .XXX ±0.05 ANGLES ±1°	审核 (CHKD):	料号(PART NO): LB615-HxxM-C1L
修订 (REV) A	比例(SCALE) 1:8	单位(UNITS) mm
修改摘要 REVISION DESCRIPTION	张数(SHEET) 1 OF 1	图幅(SIZE) A4
签名 SIGNATURE	核准 (APPD):	
日期 DATE		



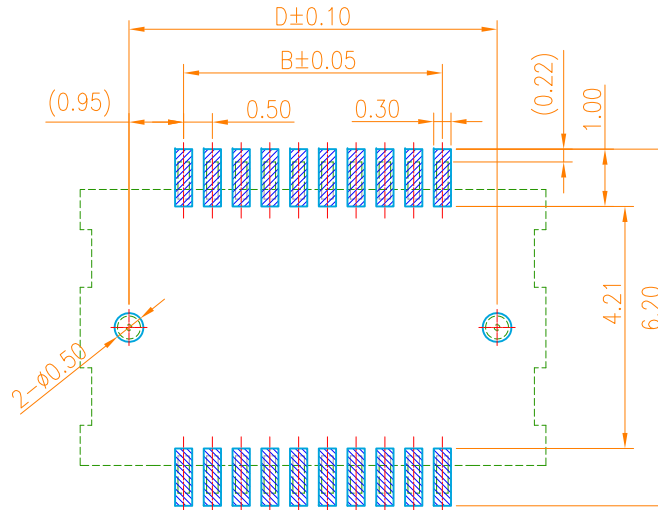
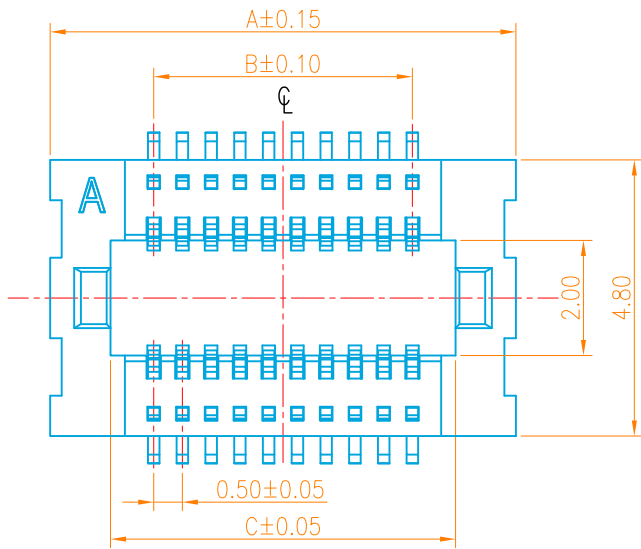

**RECOMMENDED PCB PATTERN DIM.**  
TOLERANCE : ±0.05

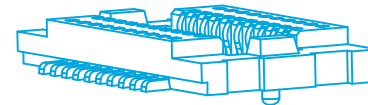
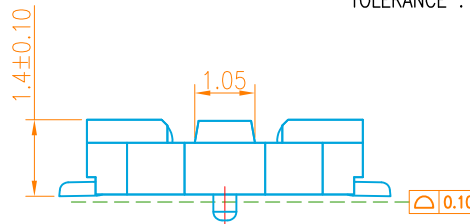
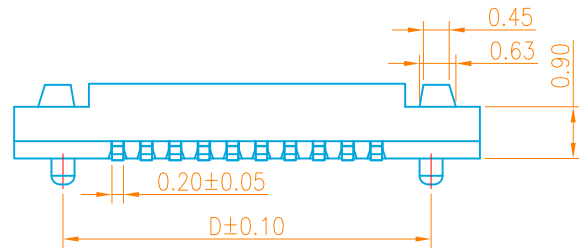

**3D VIEW**

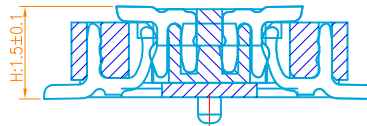
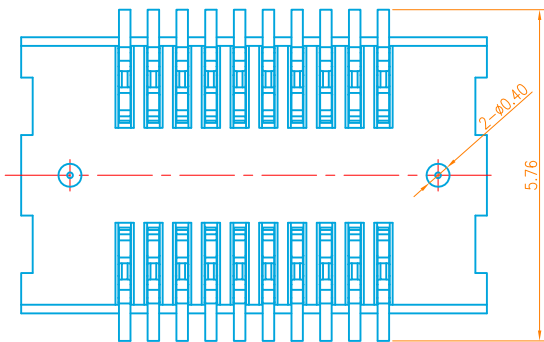

**MATING HEIGHT**

**NOTES:**

- 1.HUOSING: LCP HIGH-TEMP THERMOPLASTIC UL94V-0 COLOR:BEIGE
- 2.TERMINAL:PHOSPHOR BRONZE  
PLATING:1μ" GOLD FLASH OVERALL 50~100μ" NICKEL UNDER PLATED.
- 3.CODING INFORMATION: LB615-GxxS-C1R

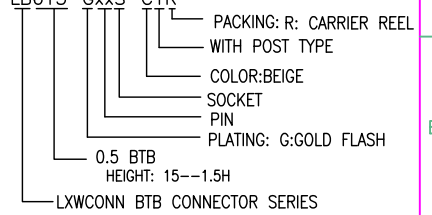

NO.of contacts	Dimensions			
	A.	B.	C.	D.
10	5.60	2.00	3.50	3.90
12	6.10	2.50	4.00	4.40
16	7.10	3.50	5.00	5.40
18	7.60	4.00	5.50	5.90
20	8.10	4.50	6.00	6.40
14	6.60	3.00	4.50	4.90
16	7.10	3.50	5.00	5.40
18	7.60	4.00	5.50	5.90
20	8.10	4.50	6.00	6.40
22	8.60	5.00	6.50	6.90
24	9.10	5.50	7.00	7.40
26	9.60	6.00	7.50	7.90
28	10.10	6.50	8.00	8.40
30	10.60	7.00	8.50	8.90
32	11.10	7.50	9.00	9.40
36	12.10	8.50	10.00	10.40
40	13.10	9.50	11.00	11.40
50	15.60	12.00	13.50	13.90
100	28.10	24.50	26.00	26.40



**CUSTOMER**



**连兴旺电子(深圳)有限公司**

LXWCONN ELECTRONICS (SHENZHEN) CO., LTD

一般公差  
GENERAL TOLERANCE

制图 (DR): Kavin  
2017.10.23

品名(TITLE): 0.5mm 单槽BTB SOCKET (定位柱)

.X ±0.25  
.XX ±0.15  
.XXX ±0.05  
ANGLES ±1°

审核 (CHKD):

料号(PART NO): LB615-HxxF-C1L

版本 (REV) A



核准 (APPD):

比例(SCALE) 1:8

单位(UNITS) mm

张数(SHEET) 1 OF 1

图幅(SIZE) A4

修订 (REV)	修改摘要 (REVISION DESCRIPTION)	签名 (SIGNATURE)	日期 (DATE)