

NOTES:

- HUOSING: PA9T HIGH-TEMP THERMOPLASTIC UL94V-0 COLOR:CREAM-COLOURED
- TERMINAL:PHOSPHOR BRONZE
PLATING:1μ" GOLD FLASH OVERALL 50~100μ" NICKEL UNDER PLATED.
- CODING INFORMATION: LB100-GxxP-COR

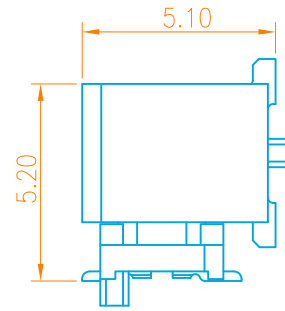

MATING HEIGHT
SCALE:1.25:1

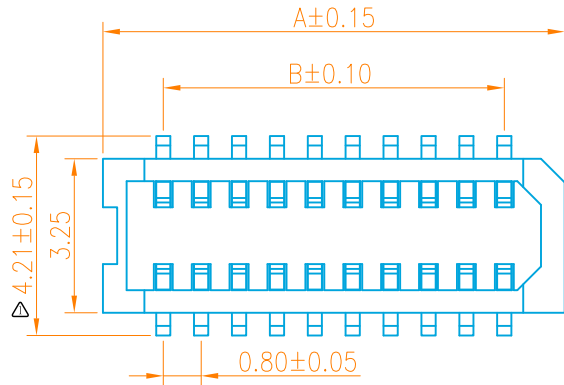
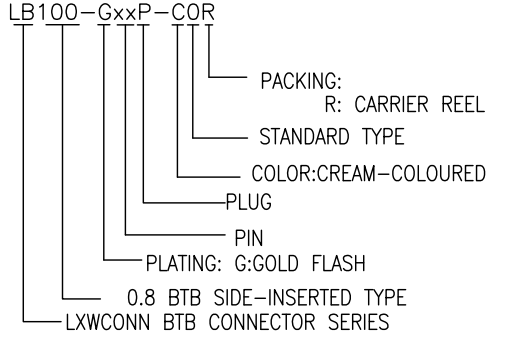
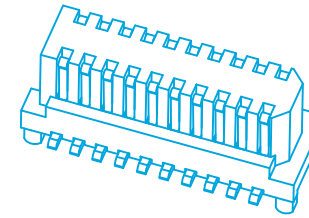
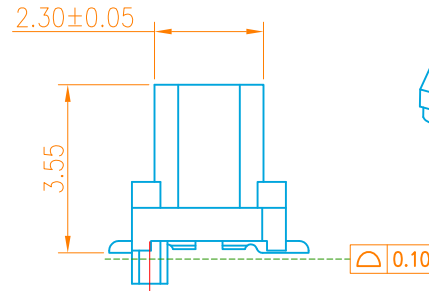
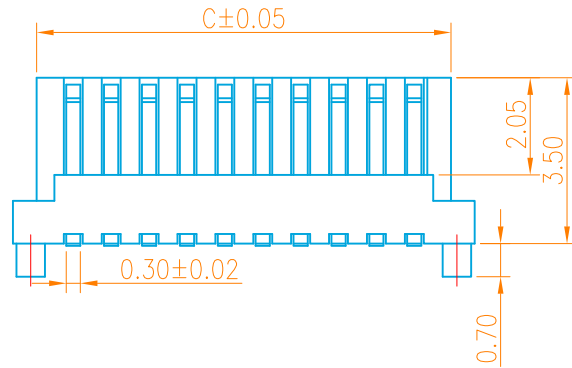

3D VIEW

NO. of contacts	Dimensions			
	A.	B.	C.	D.
4	3.35	0.80	2.35	2.60
6	4.15	1.60	3.15	3.40
8	4.95	2.40	3.95	4.20
10	5.75	3.20	4.75	5.00
12	6.55	4.00	5.55	5.80
14	7.35	4.80	6.35	6.60
16	8.15	5.60	7.15	7.40
18	8.95	6.40	7.95	8.20
20	9.75	7.20	8.75	9.00
22	10.55	8.00	9.55	9.80
24	11.35	8.80	10.35	10.60
26	12.15	9.60	11.15	11.40
28	12.95	10.40	11.95	12.20
30	13.75	11.20	12.75	13.00
32	14.55	12.00	13.55	13.80
34	15.35	12.80	14.35	14.60
36	16.15	13.60	15.15	15.40
38	16.95	14.40	15.95	16.20
40	17.75	15.20	16.75	17.00
42	18.55	16.00	17.55	17.80
44	19.35	16.80	18.35	18.60
46	20.15	17.60	19.15	19.40
48	20.95	18.40	19.95	20.20
50	21.75	19.20	20.75	21.00
52	22.55	20.00	21.55	21.80

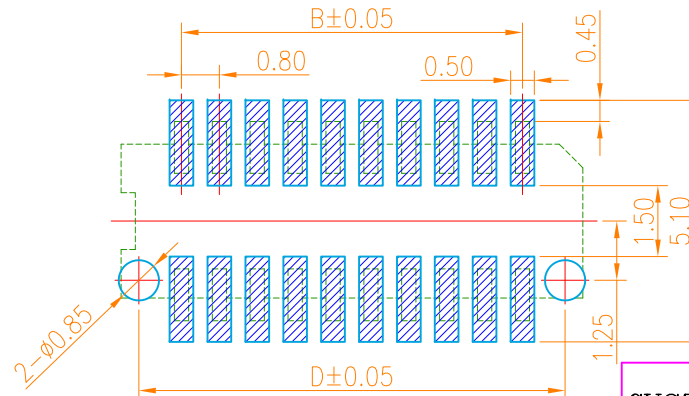
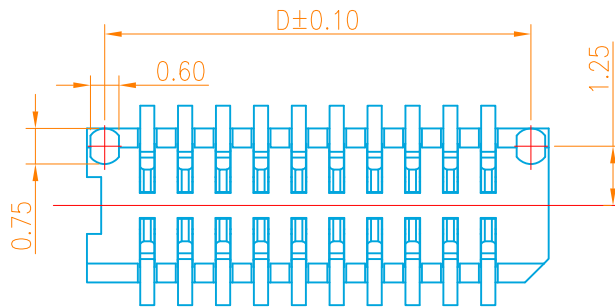

RECOMMENDED PCB PATTERN DIM.
TOLERANCE : ±0.05

CUSTOMER



连兴旺电子(深圳)有限公司

LXWCONN ELECTRONICS (SHENZHEN) CO., LTD

一般公差 GENERAL TOLERANCE .X ±0.25 .XX ±0.15 .XXX ±0.05 ANGLES ±1°	Revin 2016.07.05	品名(TITLE): 0.8mm 侧插BTB PLUG
Revin 08/15/17	审核(CHKD):	料号(PART NO): LB100-GxxP-COR
版本(REV) B	比例(SCALE) 1:8	单位(UNITS) mm
张数(SHEET) 1 OF 1	图幅(SIZE) A4	

RoHS Compliant
2013/95/EC



新增焊锡脚位尺寸	Revin	08/15/17
修改摘要 REVISION DESCRIPTION	签名 SIGNATURE	日期 DATE

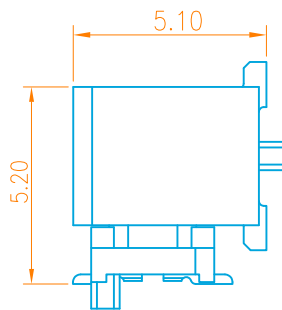
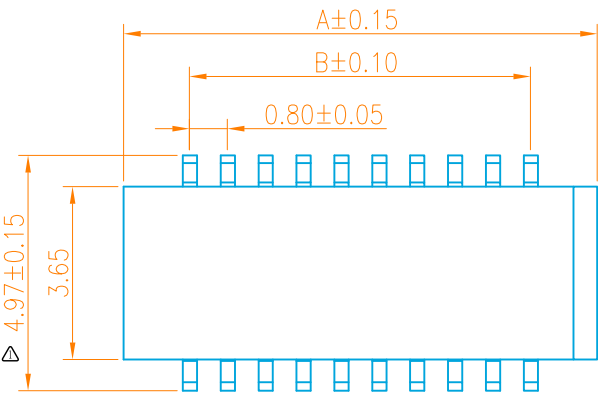

MATING HEIGHT
SCALE:1.25:1

NOTES:

- HUOSING: PA9T HIGH-TEMP THERMOPLASTIC UL94V-0 COLOR:CREAM-COLOURED
- TERMINAL:PHOSPHOR BRONZE
PLATING:1μ" GOLD FLASH OVERALL 50~100μ" NICKEL UNDER PLATED.
- CODING INFORMATION: LB100-GxxS-COR

- PACKING:
R: CARRIER REEL
- STANDARD TYPE
- COLOR:CREAM-COLOURED
- SOCKTE
- PIN
- PLATING: G:GOLD FLASH
- 0.8 BTB SIDE-INSERTED TYPE
- LXWCONN BTB CONNECTOR SERIES

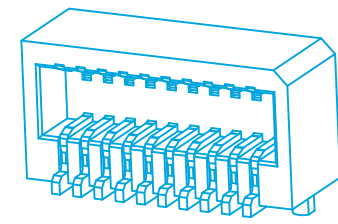

3D VIEW

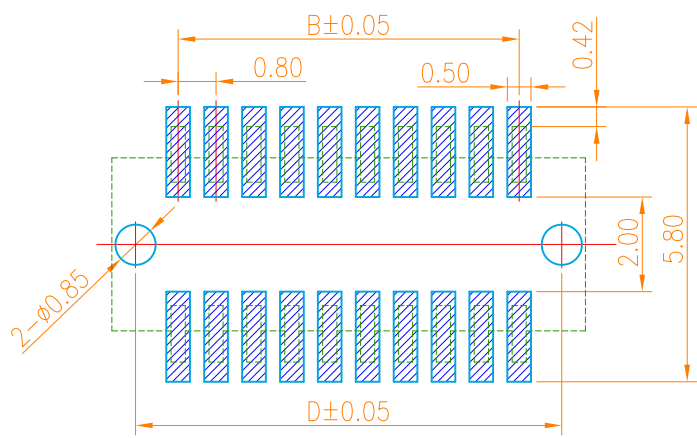
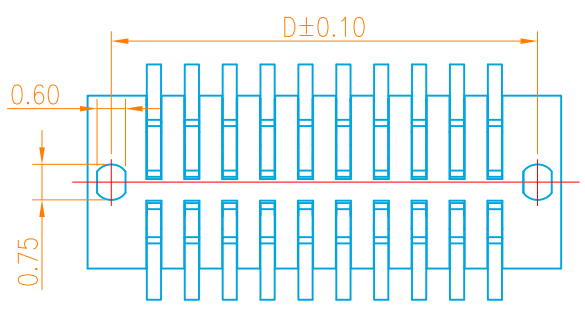
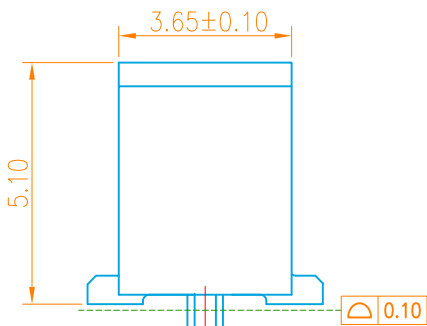
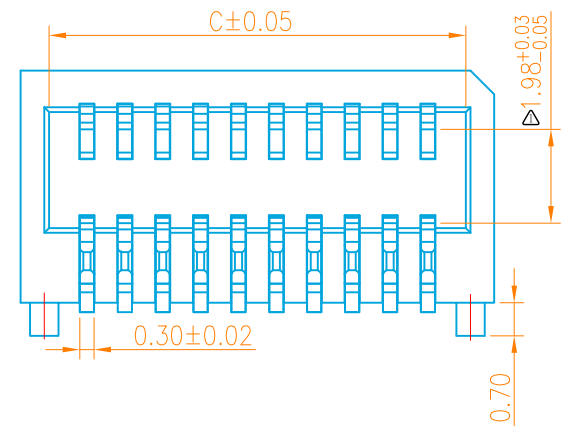

RECOMMENDED PCB PATTERN DIM.
TOLERANCE : ±0.05

No. of contacts	Dimensions			
	A.	B.	C.	D.
4	3.60	0.80	2.40	2.60
6	4.40	1.60	3.20	3.40
8	5.20	2.40	4.00	4.20
10	6.00	3.20	4.80	5.00
12	6.80	4.00	5.60	5.80
14	7.60	4.80	6.40	6.60
16	8.40	5.60	7.20	7.40
18	9.20	6.40	8.00	8.20
20	10.00	7.20	8.80	9.00
22	10.80	8.00	9.60	9.80
24	11.60	8.80	10.40	10.60
26	12.40	9.60	11.20	11.40
28	13.20	10.40	12.00	12.20
30	14.00	11.20	12.80	13.00
32	14.80	12.00	13.60	13.80
34	15.60	12.80	14.40	14.60
36	16.40	13.60	15.20	15.40
38	17.20	14.40	16.00	16.20
40	18.00	15.20	16.80	17.00
42	18.80	16.00	17.60	17.80
44	19.60	16.80	18.40	18.60
46	20.40	17.60	19.20	19.40
48	21.20	18.40	20.00	20.20
50	22.00	19.20	20.80	21.00
52	22.80	20.00	21.60	21.80



CUSTOMER		连兴旺电子(深圳)有限公司 LXWCONN ELECTRONICS (SHENZHEN) CO., LTD	
一般公差 GENERAL TOLERANCE .X ±0.25 .XX ±0.15 .XXX ±0.05 ANGLES ±1°	制图 (DR): KavIn 2016.07.05	品名(TITLE): 0.8mm 侧插BTB SOCKET	
修订 SER	新增焊锡脚位尺寸及接触GAP值 修改摘要 REVISION DESCRIPTION	审核 (CHKD): KavIn 2016.07.05	料号(PART NO): LB100-GxxS-COR 比例(SCALE) 单位(UNITS) 张数(SHEET) 图幅(SIZE) 1:8 mm 1 OF 1 A4
版本 (REV) B	日期 DATE 08/15/17	核准 (APPD):	